

SCHA-014

Heavy duty proximity switch (1.5 - 3mm)



Highlights

- Heavy duty submersible proximity switch.
- Designed for detection of (stainless) steel objects on subsea vehicles, cylinders and constructions.
- Submersible down to 5000 msw.
- Corrosion resistant AISI 316L stainless steel housing.
- Equipped with open collector PNP output
- Fitted with MCBH3MSS subsea connector

Specifications

Mechanical		Environmental	
- Housing material	AISI 316L	- Depth rate	5000 msw
- Dimensions	See figure	- Operating temperature water	-4...+60 °C
		- Operating temperature air	-40...+60 °C

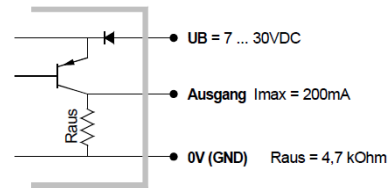
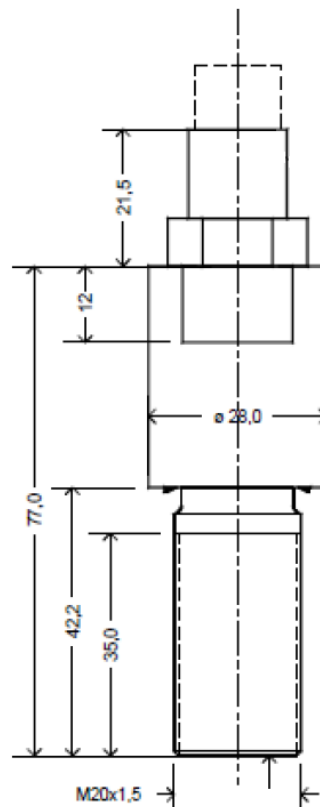

Pin 1 0V (GND)
Pin 2 UB = 7 ... 30 VDC
Pin 3 Signalausgang

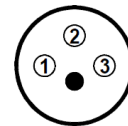

Electrical

Sensor	
- Output	PNP, see figure
- Supply voltage	7...30 VDC
- Switch current	200mA max.
- Output impedance	4.7 kΩ
- switching distance	1,5-3mm*

*Switching distance can be increased using a magnet.